

# Chicago Lakefront 50/50- 50 Kilometer Course

Chicago, Illinois

Measured by Jay Wight- Hoffman Estates, Illinois- 2 October 2011

[jaywight@earthlink.net](mailto:jaywight@earthlink.net)

MAP NOT TO SCALE

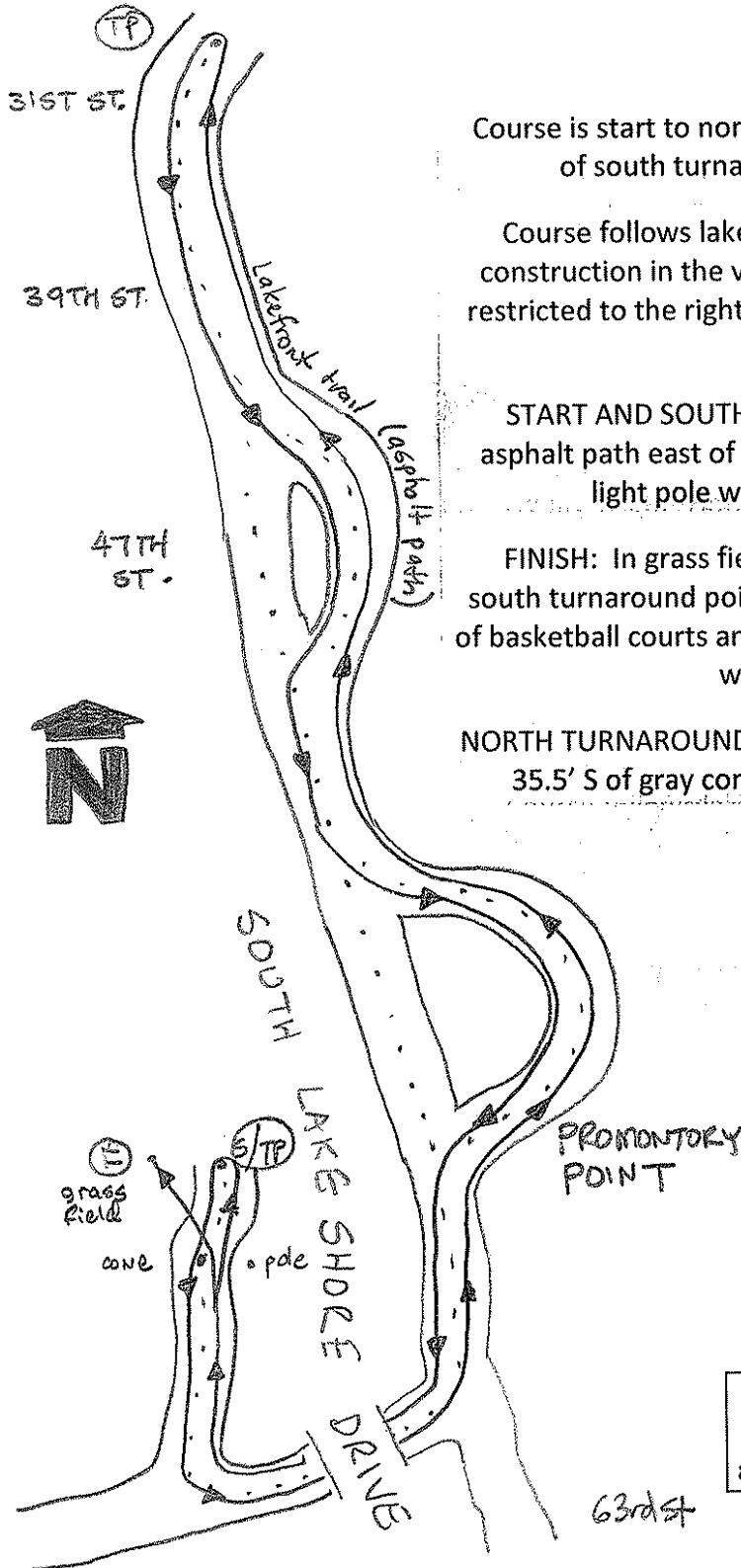

Course is start to north turnaround to finish plus two laps of south turnaround to north turnaround and back

Course follows lakefront trail, to include detour around construction in the vicinity of 31<sup>st</sup> Street. Participants are restricted to the right side of the center line of the path in both directions.

**START AND SOUTH TURNAROUND:** Mag nail, center of asphalt path east of Grove 19, 69' north of northernmost light pole with globe fixture on east side of path.

**FINISH:** In grass field north of basketball courts west of south turnaround point, 110' NE of light pole at NE corner of basketball courts and 97' NW of northernmost light pole with globe fixture on east side of path.

**NORTH TURNAROUND:** Mag nail, center of lakefront path, 35.5' S of gray concrete pole on E side of path just N of Lakefront Trail 11.5 mile sign.

International® Brand

19 292 50 SHEETS, FULLER 5 SQUARE  
42 291 50 SHEETS, FULLER 5 SQUARE  
42 292 100 SHEETS, FULLER 5 SQUARE  
42 293 200 SHEETS, FULLER 5 SQUARE  
42 294 200 SHEETS, FULLER 5 SQUARE  
42 295 200 RECOILED WHITE 5 SQUARE  
MADE IN U.S.A.

## IL-11133-JW

Notice to Race Director: Use this Certification Code in all public announcements relating to your race.

**COURSE CERTIFICATION EFFECTIVE  
FROM 20 OCTOBER 2011  
THROUGH 31 DECEMBER 2021**